



**Equipment Sales**  
815 Allgood Road • Marietta, GA 30062  
USA  
Tel: (770) 422-7230 • Fax (770) 428-7315  
www.tugtech.com

**Parts Sales**  
TUG Shop: (800) 989-8499 \* (770) 422-8021  
Fax: (770) 422-8730  
www.tugparts.com



## **Model MA**

### **Baggage and Cargo Towing Tractor**

The MA is a time-tested, field proven tow tractor with 3,000 to 6,000 pounds (1,362 to 2,722 kg) drawbar pull to handle all of your cargo and baggage towing requirements and to provide pushback for private and regional aircraft with a MTOW up to 60,000 pounds (27,220 kg). All models are equipped with gasoline, diesel or LPG fueled engines. An enclosed cabin and other options are available. Other features include solid-state ignition, engine emission control, automatic transmission and disc brakes on the rear wheels operated via a dual hydraulic system. Simple, rugged and easy access to all components assure long life on even the most demanding ramps.



#### **Standard features include:**

- Recessed headlights
- Combination tail and stop lights
- Power boosted disc brake system
- Automatic transmission
- Seat belts
- Non-slip surface on floor boards
- Non-slip surface on brake pedal
- Engine speed governor
- Adjustable over center park brake lever
- Split braking systems
- Front, rear & side reflectors

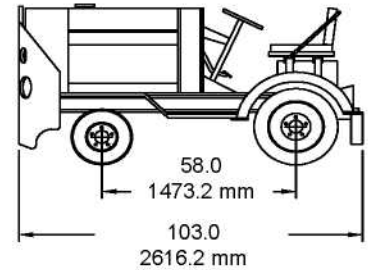
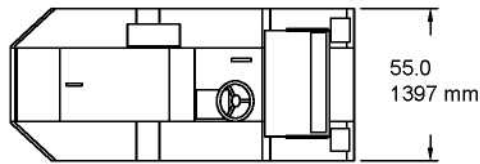
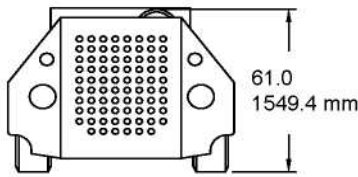

# Specifications Model MA Tow Tractor

### Dimensions

Length excluding coupler..... 103" (2616.2 mm)  
 Width..... 55.0" (1397.0 mm)  
 Height less cab ..... 61" (1549.4 mm)  
 Height with cab ..... 82.5" (2095.5 mm)  
 Wheelbase ..... 59" (1498.6 mm)  
 Minimum ground clearance ..... 6.5" (165.1 mm)  
 Steer axle under clearance ..... 7.8" (198.12 mm)  
 Frame under clearance ..... 10" (254.0 mm)  
 Turning radius ..... 115" (2921.0 mm)  
 Maximum governed speed..... 15 mph (24.14 kph)

### Drawbar Pull by Model

Model	Drawbar Pull	GVW
MA30	3000 lb (1362 kg)	3750lb (1701 kg)
MA40	4000lb (1816 kg)	5000lb (2268 kg)
MA50	5000 lb (2268 kg)	6250lb (2835 kg)
MA60	6000 lb (2722 kg)	7500lb (3402 kg)

### Engine Options

#### Ford ESG-642 EFI Gasoline

Type.....Water-cooled, EFI, V6  
 Fuel .....No-lead regular, 87 octane  
 Displacement ..... 256 CID (4.2 L)  
 Governed rpm with full load ..... 2600  
 Net brake hp at governed rpm..... 125 (93 kW)  
 Torque at 2600 rpm..... 240 lb ft (325 Nm)

#### Perkins 1104C-44 Diesel

Type .....Water-cooled, direct injected, in-line, 4 cylinder  
 Fuel ..... Diesel or Jet A (with additive)  
 Displacement..... 269 CID (4.4 L)  
 Governed rpm with full load ..... 2400  
 Net brake hp at governed rpm ..... 86 (64kW)  
 Torque at 1400 rpm..... 222 lb ft (302 Nm)

#### Deutz F4M2011 Diesel

Type.....Oil-cooled, direct injected in-line, 4 cylinder  
 Fuel ..... Diesel or Jet A  
 Displacement..... 189 CID (3.1 L)  
 Governed rpm with full load ..... 2500  
 Net brake hp at governed rpm .....65 (48.5 kW)  
 Torque at 1700 rpm.....140 lb ft (190 Nm)

### Transmission

Gasoline  
 Type..... Ford industrial 2-speed automatic transmission w/torque converter  
 Diesel  
 Type..... Ford industrial 3-speed automatic transmission w/torque converter

### Drive Axle

Type..... Heavy-duty 6,000 lb capacity axle with drop box

### Drive Shaft

Type .Double universal, sliding spline coupling

### Electrical System

Type..... 12 V, negative ground  
 Alternator ..... 91 A

### Cooling System

Engine ..... 15 qt (14.2 L)  
 Heavy-duty radiator and fan  
 Transmission ..... Radiator cooled

### Fuel System

Fuel Cell Capacity ..... 15.5 U.S. gal (58.67 L)  
 Fuel options ..... Gasoline, diesel or LP

### Brakes System

Service .....Dual split system, vacuum boosted with four calipers on the rear axle and 13-inch cast iron rotors  
 Parking .....Lever operated, drum type

### Steering System

Type..... Ball and screw gearbox, heavy-duty front steer axle with inclined king pins,  
 bushings and bearings

### Suspension

Front ..... Leaf springs  
 Rear..... Rubber mount

### Tires

Front .....20.5 x 8 x 10, 6-ply rating  
 Rear.....8 x 16.5, 8-ply rating

### Hitch

Standard "E" hitch ..... Other options available

### Instruments

#### Diesel Powered

Water temperature, Oil pressure, Ammeter, Hour meter

#### Gasoline Powered

Hour meter  
 Engine Performance Module (EPM) Indicator light

### Partial List of Options

- Cab
- Overhead guard
- Fuel gauge on instrument panel
- Backup alarm
- Snow plow
- Charlyn hydraulic steering
- Additional hitches to fit customer specifications
- Others available upon request



**Equipment Sales**  
 815 Allgood Road • Marietta, GA 30062 USA  
 Tel: (770) 422-7230 • Fax (770) 428-7315  
 www.tugtech.com

**Parts Sales**  
 TUG Shop: (800) 989-8499 \* (770) 422-8021  
 Fax: (770) 422-8730  
 www.tugparts.com